

Oxygen System

King Air 200; B200

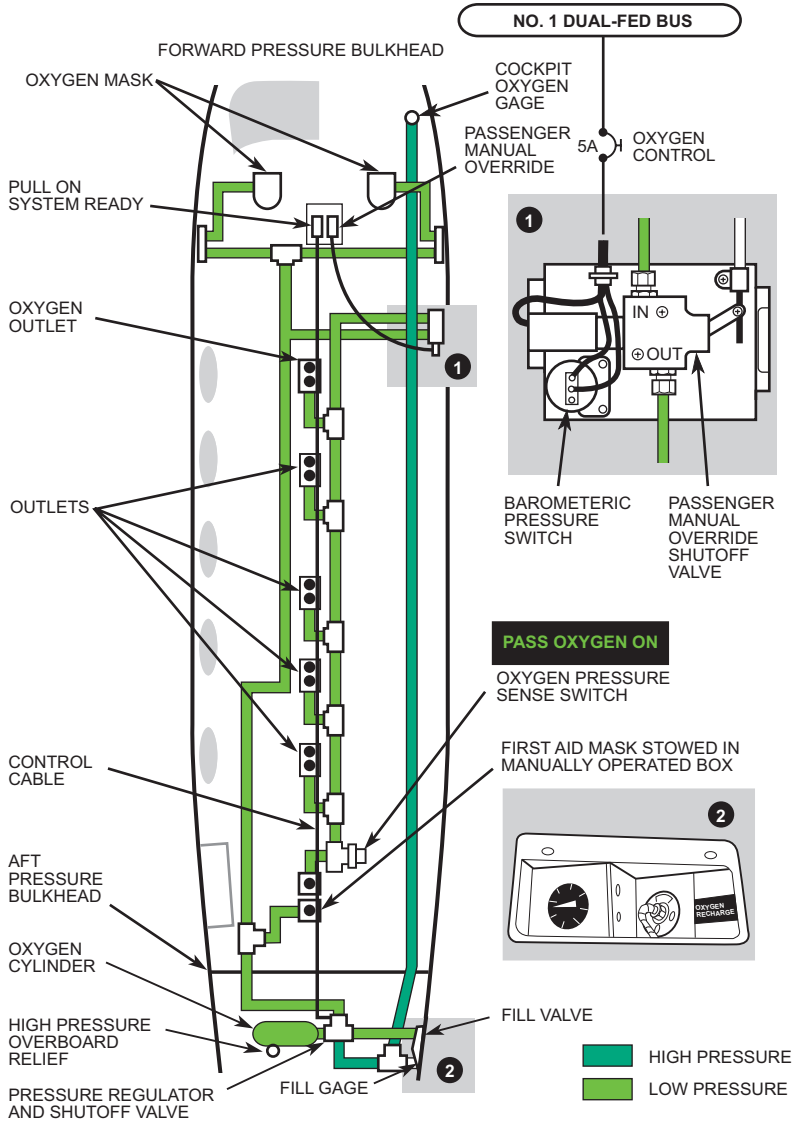

Oxygen System King Air 200C (With Cargo Door)

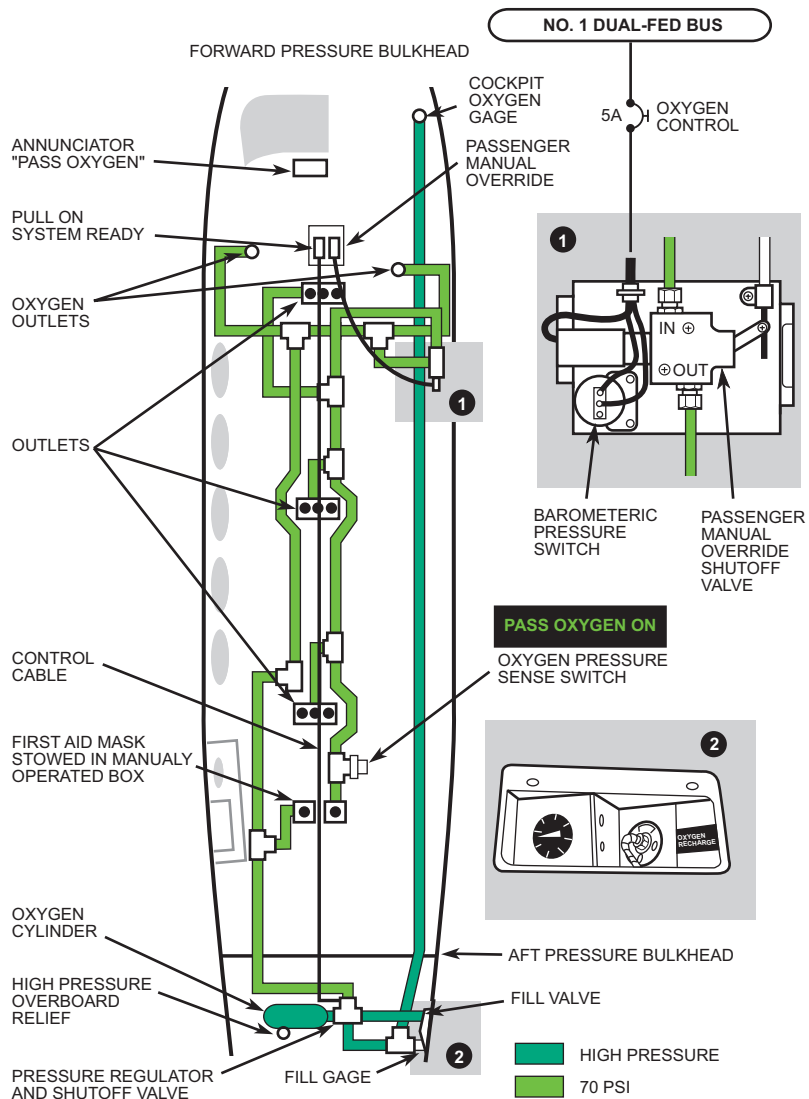

Oxygen System

The oxygen bottle supplies both the passenger and crew oxygen systems through an integral pressure regulator. The bottle has high pressure ports for the fill line and bottle pressure gage. If it overpressurizes, a relief disc bursts to vent the oxygen overboard to the atmosphere.

Bottle size depends on aircraft model and options. On **aircraft BB-44 to 309, 311 to 328; earlier aircraft with kits 101-5006 and 101-5007 or with the autodeployment system installed**, the 22 ft³ bottle is standard; 49, 64, or 76 ft³ bottles are options. On **aircraft BB-310, 239 to 1438, 1440 to 1443; BL-1 to 139**, the 22 ft³ steel bottle is standard; 49, 64, 76, or 115 ft³ bottles are options. On **aircraft BB-1439, 1444 and subsequent; BL-139 and subsequent**, the 22 ft³ bottle is standard; 50, 77, or 115 ft³ bottles are options.

Crew System

Oxygen first flows through the bottle regulator where normal bottle pressure is reduced to 70 mechanically operated by the PULL ON SYS READY knob. With the knob pulled out, the shutoff valve opens and oxygen flow is available to crew masks and the first aid mask.

The crew oxygen masks are diluter-demand types that provide oxygen as the wearer inhales. Each mask has a NORMAL (N)/100% lever to control oxygen dilution. With the lever in NORMAL, the mask dilutes the oxygen with ambient air for use up to an altitude of 20,000 ft. Placing the lever in the 100% position provides undiluted oxygen.

Passenger System

For the passenger oxygen system, oxygen continues its flow from the mechanically operated crew system shutoff valve to a second shutoff valve controlled by a barometric pressure switch. When cabin altitude reaches 12,500 ft, the barometric pressure switch opens the passenger shutoff valve and oxygen flows into the passenger mask autodeployment boxes. The pressure deploys the passenger masks and pulling the lanyard pin on the mask starts oxygen flow to the mask. Pressure in supply lines of the passenger system illuminates the green PASS OXY ON annunciator.

Override System

If the barometric switch fails, pull the PASSENGER OXYGEN O'RIDE knob to mechanically open the passenger system shut-off valve. When passenger oxygen is no longer required, push the O'RIDE knob in and pull the OXYGEN CONTROL CB to stop oxygen flow to the passenger system.